

YBBP 系列隔爆型变频调速三相异步电动机

YBBP Series Flameproof Variable- frequency Adjustable-speed Induction Motors



机座号 80~355

功率 0.18~315kW

2、4 极变频范围：（3）5~ 60、100Hz

6、8、10 极变频范围：（3）5~ 100Hz

绝缘等级 F 额定电压：380V、660V、380V/660V

适用于：含有甲烷等气体的工厂（Ex d IIAT4、d IIBT4）含有 II 类 A、B 级 T1~T4 组的可燃性气体或蒸汽与空气形成的爆炸性混合物的场所。

Applications: Ideal for the plant or workshop (Ex d IIAT4、d IIBT4) where dangerous explosive mixture of air with T1~T4 class II A II B flammable substance in the form of gas or vapor is present.

特点：

- 无级调速、调速范围宽
- 系统调速性能好、节能效果更显著
- 采用耐高频脉冲电压冲击的绝缘材料和工艺
- 独立风机强制通风冷却

Features:

- Stepless adjustable speed operation in a wide range
- Good performance of the system, energy saving
- High-grade insulation material and special technological withstand high frequency pulse impact
- Separate fan for forced- ventilation

性能数据

Performance Data

额定电压：380V

基频：50Hz

| 型号 Type | 功率 kW | 额定 电流 A | 转速 r/min | 效率 Eff.% | 功率 因数 P.F | 额定 转矩 N.m | 噪声 dB(A) | 恒转矩调频范围 Constant Torque Frequency Range Hz | 恒功率调频范围 Constant Output Frequency Range Hz |
|----------------|----------|---------------|-------------|-------------|-----------------|-----------------|-------------|---|---|
| 同步转速 3000r/min | | | | | | | | | |
| YBBP80M1-2 | 0.75 | 1.83 | 2845 | 75.0 | 0.83 | 2.3 | 70 | (3)5-50 | 50-100 |
| YBBP80M2-2 | 1.1 | 2.55 | 2845 | 78.0 | 0.84 | 3.5 | 70 | | |
| YBBP90S-2 | 1.5 | 3.43 | 2840 | 79.0 | 0.84 | 4.7 | 74 | | |
| YBBP90L-2 | 2.2 | 4.85 | 2840 | 81.0 | 0.85 | 7 | 74 | | |
| YBBP100L-2 | 3 | 6.24 | 2860 | 83.0 | 0.88 | 9.5 | 78 | | |
| YBBP112M-2 | 4 | 8.13 | 2880 | 85.0 | 0.88 | 12.7 | 82 | | |
| YBBP132S1-2 | 5.5 | 11.0 | 2900 | 86.0 | 0.88 | 17.5 | 85 | | |
| YBBP132S2-2 | 7.5 | 14.9 | 2900 | 87.0 | 0.88 | 23.8 | 85 | | |
| YBBP160M1-2 | 11 | 21.5 | 2930 | 88.4 | 0.88 | 35 | 87 | | |
| YBBP160M2-2 | 15 | 28.6 | 2930 | 89.4 | 0.89 | 47.7 | 87 | | |
| YBBP160L-2 | 18.5 | 35.1 | 2930 | 90.0 | 0.89 | 58.8 | 87 | | |
| YBBP180M-2 | 22 | 41.0 | 2940 | 90.5 | 0.90 | 70.5 | 90 | | |
| YBBP200L1-2 | 30 | 55.4 | 2950 | 91.4 | 0.90 | 95.4 | 92 | | |
| YBBP200L2-2 | 37 | 67.9 | 2950 | 92.0 | 0.90 | 117.7 | 92 | | |
| YBBP225M-2 | 45 | 82.1 | 2960 | 92.5 | 0.90 | 143.2 | 94 | | |

性能数据 Performance Data

额定电压: 380V 基频: 50Hz

| 型号 Type | 功率 kW | 额定 电流 A | 转速 r/min | 效率 Eff.% | 功率 因数 P.F | 额定 转矩 N.m | 噪声 dB(A) | 恒转矩调频范围 Constant Torque Frequency Range Hz | 恒功率调频范围 Constant Output Frequency Range Hz | |
|----------------|----------|---------------|-------------|-------------|-----------------|-----------------|-------------|---|---|-------|
| 同步转速 3000r/min | | | | | | | | | | |
| YBBP250M-2 | 55 | 99.8 | 2965 | 93.0 | 0.90 | 175 | 96 | (3)5-50 | 50-60 | |
| YBBP280S-2 | 75 | 134 | 2970 | 93.6 | 0.91 | 238.7 | 98 | | | |
| YBBP280M-2 | 90 | 160 | 2970 | 93.9 | 0.91 | 286.4 | 98 | | | |
| YBBP315S-2 | 110 | 195 | 2975 | 94.0 | 0.91 | 350.1 | 100 | | | |
| YBBP315M-2 | 132 | 233 | 2975 | 94.5 | 0.91 | 420.1 | 100 | | | |
| YBBP315L1-2 | 160 | 282 | 2975 | 94.6 | 0.91 | 509.2 | 100 | | | |
| YBBP315L2-2 | 200 | 352 | 2975 | 94.8 | 0.91 | 636.6 | 100 | | | |
| YBBP355S-2 | 200 | 352 | 2980 | 94.8 | 0.91 | 636.6 | 103 | | | |
| YBBP355M-2 | 250 | 438 | 2980 | 95.2 | 0.91 | 795.7 | 103 | | | |
| YBBP355L-2 | 315 | 551 | 2980 | 95.4 | 0.91 | 1002.6 | 103 | | | |
| 同步转速 1500r/min | | | | | | | | | | |
| YBBP80M1-4 | 0.55 | 1.57 | 1390 | 71.0 | 0.75 | 3.5 | 62 | (3)5-50 | 50-100 | |
| YBBP80M2-4 | 0.75 | 2.03 | 1390 | 73.0 | 0.77 | 4.7 | 62 | | | |
| YBBP90S-4 | 1.1 | 2.85 | 1390 | 76.2 | 0.77 | 7.0 | 64 | | | |
| YBBP90L-4 | 1.5 | 3.68 | 1390 | 78.5 | 0.79 | 9.5 | 64 | | | |
| YBBP100L1-4 | 2.2 | 5.09 | 1410 | 81.0 | 0.81 | 14 | 68 | | | |
| YBBP100L2-4 | 3 | 6.73 | 1410 | 82.6 | 0.82 | 19 | 68 | | | |
| YBBP112M-4 | 4 | 8.80 | 1440 | 84.2 | 0.82 | 25.4 | 72 | | | |
| YBBP132S-4 | 5.5 | 11.6 | 1440 | 86.0 | 0.84 | 35 | 76 | | | |
| YBBP132M-4 | 7.5 | 15.4 | 1440 | 87.0 | 0.85 | 47.7 | 76 | | | |
| YBBP160M-4 | 11 | 22.2 | 1460 | 88.4 | 0.85 | 70 | 79 | | | |
| YBBP160L-4 | 15 | 30.0 | 1460 | 89.4 | 0.85 | 95.4 | 79 | | | |
| YBBP180M-4 | 18.5 | 36.5 | 1470 | 90.5 | 0.85 | 117.7 | 83 | | | |
| YBBP180L-4 | 22 | 43.1 | 1470 | 91.2 | 0.85 | 140 | 83 | | | |
| YBBP200L-4 | 30 | 57.6 | 1470 | 92.0 | 0.86 | 190.9 | 85 | | | |
| YBBP225S-4 | 37 | 69.9 | 1475 | 92.5 | 0.87 | 235.5 | 88 | | | |
| YBBP225M-4 | 45 | 84.7 | 1475 | 92.8 | 0.87 | 286.4 | 88 | | | |
| YBBP250M-4 | 55 | 103 | 1480 | 93.0 | 0.87 | 350.1 | 92 | | | |
| YBBP280S-4 | 75 | 140 | 1480 | 93.8 | 0.87 | 477.7 | 94 | | | |
| YBBP280M-4 | 90 | 167 | 1480 | 94.2 | 0.87 | 572.9 | 94 | | | |
| YBBP315S-4 | 110 | 201 | 1480 | 94.5 | 0.88 | 700.2 | 96 | | | |
| YBBP315M-4 | 132 | 240 | 1480 | 94.8 | 0.88 | 840.3 | 96 | | | |
| YBBP315L1-4 | 160 | 288 | 1480 | 94.9 | 0.89 | 1018.5 | 96 | | | |
| YBBP315L2-4 | 200 | 360 | 1480 | 94.9 | 0.89 | 1273.2 | 96 | | | |
| YBBP355S-4 | 200 | 360 | 1490 | 94.9 | 0.89 | 1273.2 | 98 | | | |
| YBBP355M-4 | 250 | 443 | 1490 | 95.2 | 0.90 | 1591.5 | 98 | | | |
| YBBP355L-4 | 315 | 559 | 1490 | 95.2 | 0.90 | 2005.2 | 98 | | | 50-60 |

性能数据 Performance Data

额定电压: 380V

基频: 50Hz

| 型号 Type | 功率 kW | 额定 电流 A | 转速 r/min | 效率 Eff. % | 功率 因数 P.F | 额定 转矩 N.m | 噪声 dB(A) | 恒转矩调频范围 Constant Torque Frequency Range Hz | 恒功率调频范围 Constant Output Frequency Range Hz |
|----------------|----------|---------------|-------------|--------------|-----------------|-----------------|-------------|---|---|
| 同步转速 1000r/min | | | | | | | | | |
| YBBP80M1-6 | 0.37 | 1.27 | 885 | 63.0 | 0.70 | 3.5 | 61 | (3)5-50 | 50-100 |
| YBBP80M2-6 | 0.55 | 1.76 | 885 | 66.0 | 0.72 | 5.2 | 61 | | |
| YBBP90S-6 | 0.75 | 2.29 | 910 | 69.0 | 0.72 | 7.1 | 63 | | |
| YBBP90L-6 | 1.1 | 3.14 | 910 | 73.0 | 0.73 | 10.5 | 63 | | |
| YBBP100L-6 | 1.5 | 3.95 | 920 | 76.0 | 0.76 | 14.3 | 66 | | |
| YBBP112M-6 | 2.2 | 5.57 | 935 | 79.0 | 0.76 | 21 | 71 | | |
| YBBP132S-6 | 3 | 7.31 | 960 | 81.0 | 0.77 | 28.6 | 75 | | |
| YBBP132M1-6 | 4 | 9.39 | 960 | 83.0 | 0.78 | 38.1 | 75 | | |
| YBBP132M2-6 | 5.5 | 12.6 | 965 | 85.0 | 0.78 | 52.5 | 75 | | |
| YBBP160M-6 | 7.5 | 16.8 | 970 | 86.0 | 0.79 | 71.6 | 78 | | |
| YBBP160L-6 | 11 | 24.2 | 970 | 87.5 | 0.79 | 105 | 78 | | |
| YBBP180L-6 | 15 | 31.6 | 970 | 89.0 | 0.81 | 143.2 | 82 | | |
| YBBP200L1-6 | 18.5 | 37.6 | 980 | 90.0 | 0.83 | 176.6 | 84 | | |
| YBBP200L2-6 | 22 | 44.7 | 980 | 90.0 | 0.83 | 210 | 84 | | |
| YBBP225M-6 | 30 | 57.6 | 980 | 92.0 | 0.86 | 286.4 | 86 | | |
| YBBP250M-6 | 37 | 71.1 | 980 | 92.0 | 0.86 | 353.3 | 90 | | |
| YBBP280S-6 | 45 | 85.9 | 980 | 92.5 | 0.86 | 429.7 | 92 | | |
| YBBP280M-6 | 55 | 105 | 980 | 92.8 | 0.86 | 525.1 | 92 | | |
| YBBP315S-6 | 75 | 142 | 985 | 93.5 | 0.86 | 716.1 | 94 | | |
| YBBP315M-6 | 90 | 170 | 985 | 93.8 | 0.86 | 859.4 | 94 | | |
| YBBP315L1-6 | 110 | 207 | 985 | 94.0 | 0.86 | 1050.3 | 94 | | |
| YBBP315L2-6 | 132 | 245 | 985 | 94.2 | 0.87 | 1260.4 | 94 | | |
| YBBP355S-6 | 160 | 293 | 990 | 94.2 | 0.88 | 1527.8 | 96 | | |
| YBBP355M-6 | 200 | 365 | 990 | 94.5 | 0.88 | 1909.8 | 96 | | |
| YBBP355L-6 | 250 | 457 | 990 | 94.5 | 0.88 | 2387.2 | 96 | | |
| 同步转速 750r/min | | | | | | | | | |
| YBBP80M1-8 | 0.18 | 0.86 | 645 | 52.0 | 0.61 | 2.2 | 61 | (3)5-50 | 50-100 |
| YBBP80M2-8 | 0.25 | 1.13 | 645 | 55.0 | 0.61 | 3.1 | 61 | | |
| YBBP90S-8 | 0.37 | 1.44 | 670 | 63.0 | 0.62 | 4.7 | 63 | | |
| YBBP90L-8 | 0.55 | 2.07 | 670 | 64.0 | 0.63 | 7 | 63 | | |
| YBBP100L1-8 | 0.75 | 2.36 | 680 | 71.0 | 0.68 | 9.5 | 66 | | |
| YBBP100L2-8 | 1.1 | 3.32 | 680 | 73.0 | 0.69 | 14 | 66 | | |
| YBBP112M-8 | 1.5 | 4.40 | 690 | 75.0 | 0.69 | 19.1 | 71 | | |
| YBBP132S-8 | 2.2 | 5.80 | 705 | 79.0 | 0.73 | 28 | 75 | | |
| YBBP132M-8 | 3 | 7.71 | 705 | 81.0 | 0.73 | 38.2 | 75 | | |
| YBBP160M1-8 | 4 | 10.3 | 720 | 81.0 | 0.73 | 50.1 | 78 | | |

性能数据 Performance Data

额定电压: 380V 基频: 50Hz

| 型号 Type | 功率 kW | 额定 电流 A | 转速 r/min | 效率 Eff.% | 功率 因数 P.F | 额定 转矩 N.m | 噪声 dB(A) | 恒转矩调频范围 Constant Torque Frequency Range Hz | 恒功率调频范围 Constant Output Frequency Range Hz |
|---------------|----------|---------------|-------------|-------------|-----------------|-----------------|-------------|---|---|
| 同步转速 750r/min | | | | | | | | | |
| YBBP160M2-8 | 5.5 | 13.4 | 720 | 83.0 | 0.75 | 70 | 78 | (3)5-50 | 50-100 |
| YBBP160L-8 | 7.5 | 17.6 | 720 | 85.0 | 0.76 | 95.5 | 78 | | |
| YBBP180L-8 | 11 | 25.3 | 730 | 87.0 | 0.76 | 140.1 | 82 | | |
| YBBP200L-8 | 15 | 33.7 | 730 | 89.0 | 0.76 | 191.0 | 84 | | |
| YBBP225S-8 | 18.5 | 40.0 | 730 | 90.0 | 0.78 | 235.5 | 86 | | |
| YBBP225M-8 | 22 | 47.4 | 730 | 90.5 | 0.78 | 280.1 | 86 | | |
| YBBP250M-8 | 30 | 63.4 | 735 | 91.0 | 0.79 | 382 | 90 | | |
| YBBP280S-8 | 37 | 77.8 | 735 | 91.5 | 0.79 | 471.1 | 92 | | |
| YBBP280M-8 | 45 | 94.1 | 735 | 92.0 | 0.79 | 573 | 92 | | |
| YBBP315S-8 | 55 | 111 | 735 | 92.8 | 0.81 | 700.3 | 94 | | |
| YBBP315M-8 | 75 | 150 | 735 | 93.5 | 0.81 | 955 | 94 | | |
| YBBP315L1-8 | 90 | 180 | 735 | 93.8 | 0.81 | 1145.9 | 94 | | |
| YBBP315L2-8 | 110 | 217 | 735 | 94.0 | 0.82 | 1400.5 | 94 | | |
| YBBP355S-8 | 132 | 260 | 740 | 94.2 | 0.82 | 1680.6 | 96 | | |
| YBBP355M-8 | 160 | 315 | 740 | 94.2 | 0.82 | 2037.1 | 96 | | |
| YBBP355L-8 | 200 | 392 | 740 | 94.5 | 0.82 | 2546.4 | 96 | | |
| 同步转速 600r/min | | | | | | | | | |
| YBBP315S-10 | 45 | 99.6 | 590 | 91.5 | 0.75 | 716.2 | 92 | (3)5-50 | 50-100 |
| YBBP315M-10 | 55 | 121 | 590 | 92.0 | 0.75 | 875.3 | 92 | | |
| YBBP315L1-10 | 75 | 162 | 590 | 92.5 | 0.76 | 1193.6 | 92 | | |
| YBBP315L2-10 | 90 | 191 | 590 | 93.0 | 0.77 | 1432.4 | 92 | | |
| YBBP355M1-10 | 110 | 230 | 590 | 93.2 | 0.78 | 1750.6 | 94 | | |
| YBBP355M2-10 | 132 | 275 | 590 | 93.5 | 0.78 | 2100.8 | 94 | | |
| YBBP355L-10 | 160 | 333 | 590 | 93.5 | 0.78 | 2546.4 | 94 | | |

采用 V/f 控制的转矩特性

The torque characteristic under the condition of V/f control

采用 V/f 控制恒转矩输出时，须采用电压补偿方式，以增大低频力矩。

The voltage needs to be compensated to increase the torque at low frequency when the motor is operated under the condition of V/f control with constant torque output.

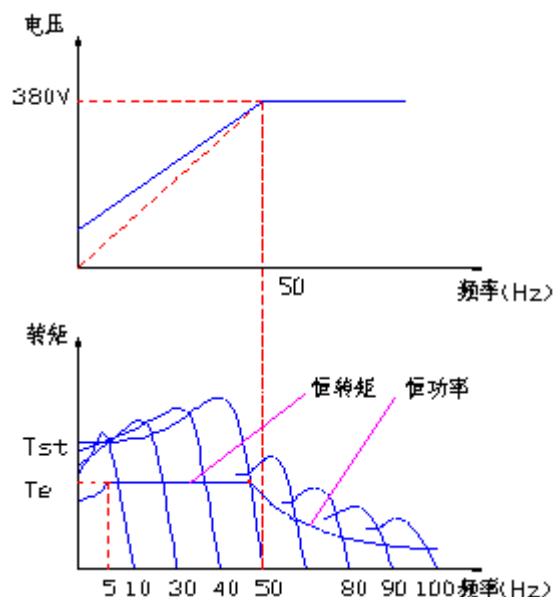

B3 (机座带底脚、端盖无凸缘)

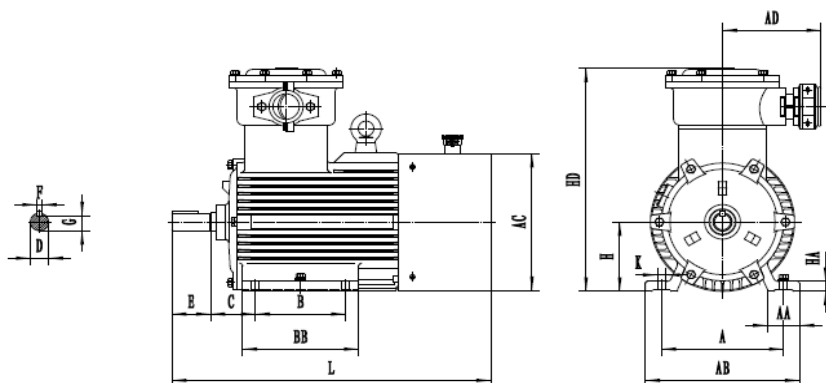

| 机座 Frame | 极数 Poles | 安 装 尺 寸 Mounting Dimension | | | | | | | | | 外 形 尺 寸 Overall Dimension | | | | | | | | | |
|-------------|-------------|----------------------------|-----|-----|-----|-----|------|------|-----|----|---------------------------|-----|----|-----|-----|-----|------|------|------|------|
| | | A | B | C | D | E | F | G | H | K | AA | BB | HA | AB | AC | AD | HD | L | | |
| 80M | 2,4,6,8 | 125 | 100 | 50 | 19 | 40 | 6 | 15.5 | 80 | 10 | 34 | 150 | 10 | 165 | 165 | 180 | 320 | 330 | | |
| 90S | 2,4,6,8 | 140 | 100 | 56 | 24 | 50 | 8 | 20 | 90 | 10 | 36 | 140 | 14 | 180 | 180 | 180 | 350 | 360 | | |
| 90L | | | 125 | | | | | | | | | 165 | | | | | | 385 | | |
| 100L | 2,4,6,8 | 160 | 140 | 63 | 28 | 60 | 8 | 24 | 100 | 12 | 40 | 190 | 14 | 200 | 205 | 180 | 400 | 440 | | |
| 112M | 2,4,6,8 | 190 | | 70 | | | | | 112 | | 50 | | | | | | | 180 | 16 | 245 |
| 132S | 2,4,6,8 | 216 | 140 | 89 | 38 | 80 | 10 | 33 | 132 | 12 | 60 | 190 | 18 | 280 | 270 | 200 | 450 | 510 | | |
| 132M | | | 178 | | | | | | | | | 230 | | | | | | 550 | | |
| 160M | 2,4,6,8 | 254 | 210 | 108 | 42 | 110 | 12 | 37 | 160 | 15 | 70 | 253 | 25 | 330 | 325 | 220 | 520 | 670 | | |
| 160L | | | 254 | | | | | | | | | 297 | | | | | | 710 | | |
| 180M | 2,4,6,8 | 279 | 241 | 121 | 48 | 110 | 14 | 42.5 | 180 | 15 | 70 | 315 | 22 | 355 | 360 | 220 | 550 | 730 | | |
| 180L | | | 279 | | | | | | | | | 350 | | | | | | 750 | | |
| 200L | 2,4,6,8 | 318 | 305 | 133 | 55 | 110 | 16 | 49 | 200 | 19 | 70 | 366 | 25 | 390 | 400 | 250 | 645 | 805 | | |
| 225S | 4,8 | 356 | 286 | 149 | 60 | 140 | 18 | 53 | 225 | 19 | 75 | 355 | 28 | 435 | 450 | 250 | 690 | 865 | | |
| 225M | 2 | | 311 | | 55 | 110 | 16 | 49 | | | | 388 | | | | | | 860 | | |
| | 4,6,8 | | 60 | | 140 | 18 | 53 | 890 | | | | | | | | | | | | |
| 250M | 2 | 406 | 349 | 168 | 60 | 140 | 18 | 53 | 250 | 24 | 80 | 420 | 30 | 490 | 500 | 300 | 730 | 945 | | |
| | 4,6,8 | | | | 65 | | | 58 | | | | | | | | | | 80 | | |
| 280S | 2 | 457 | 368 | 190 | 140 | 140 | 18 | 58 | 280 | 24 | 90 | 458 | 35 | 545 | 560 | 300 | 810 | 1010 | | |
| 280M | 4,6,8 | | | | | | | 75 | | | | | | | | | | | 20 | 67.5 |
| | 2 | | 419 | | | | | 65 | | | | | | | | | | 18 | 58 | 509 |
| | 4,6,8 | | | | | | | 75 | | | | | | | | | | 20 | 67.5 | |
| 315S | 2 | 508 | 406 | 216 | 65 | 140 | 18 | 58 | 315 | 28 | 120 | 570 | 45 | 640 | 630 | 400 | 1020 | 1320 | | |
| 315M | 4,6,8,10 | | | | 80 | 170 | 22 | 71 | | | | | | | | | | 1350 | | |
| | 2 | | 457 | | 65 | 140 | 18 | 58 | | | | | | | | | | 680 | 1350 | |
| | 4,6,8,10 | | | | 80 | 170 | 22 | 71 | | | | | | | | | | | 1380 | |
| 315L | 2 | 508 | 406 | 65 | 140 | 18 | 58 | 1490 | | | | | | | | | | | | |
| | 4,6,8,10 | | | 80 | 170 | 22 | 71 | 1520 | | | | | | | | | | | | |
| 355S | 2 | 610 | 500 | 254 | 75 | 140 | 20 | 67.5 | 355 | 28 | 116 | 636 | 50 | 740 | 750 | 500 | 1080 | 1570 | | |
| 355M | 4,6,8,10 | | | | 95 | 170 | 25 | 86 | | | | | | | | | | 1570 | | |
| | 2 | | 560 | | 75 | 140 | 20 | 67.5 | | | | | | | | | | 766 | 1650 | |
| | 4,6,8,10 | | | | 95 | 170 | 25 | 86 | | | | | | | | | | | 1650 | |
| 355L | 2 | 630 | 500 | 75 | 140 | 20 | 67.5 | 1750 | | | | | | | | | | | | |
| | 4,6,8,10 | | | 95 | 170 | 25 | 86 | 1750 | | | | | | | | | | | | |

B5 (机座不带底脚、端盖有凸缘)

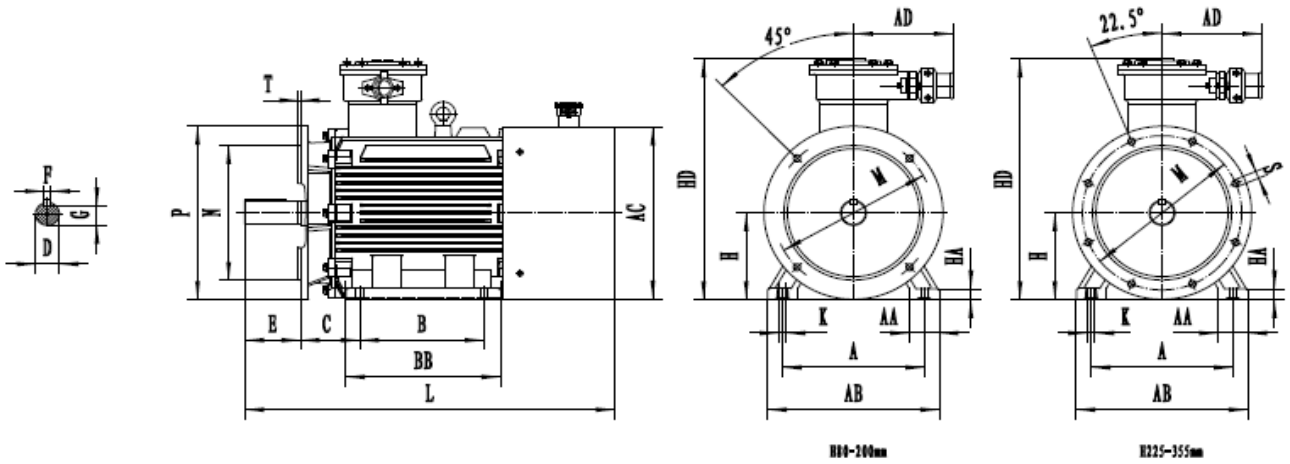

B35 (机座带底脚、端盖有凸缘)

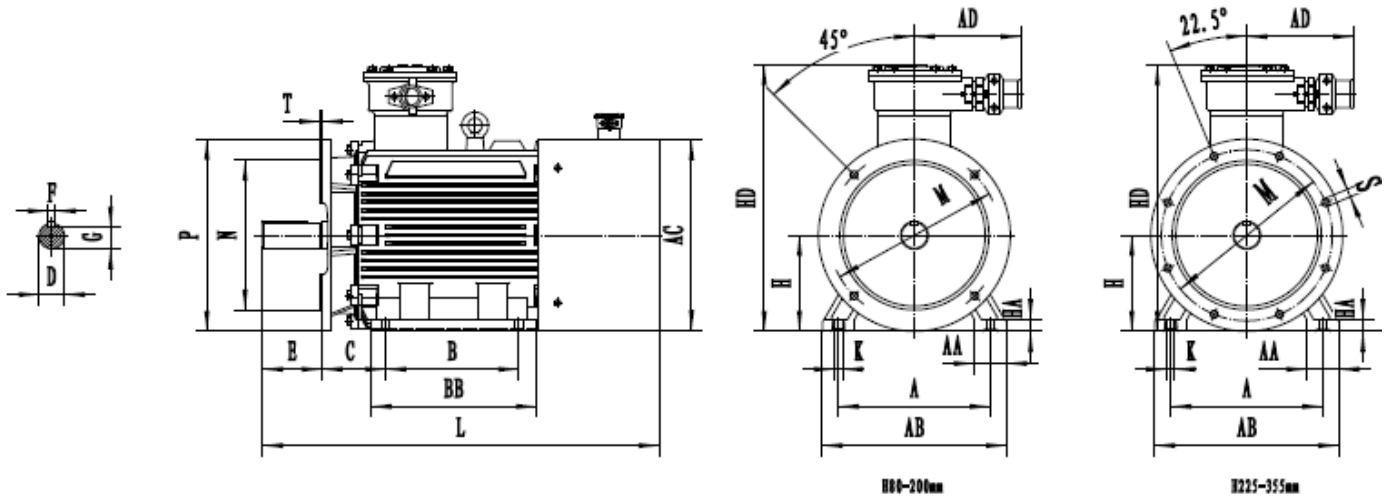

| 机座号 Frame | 极数 Poles | 安 装 尺 寸 Mounting Dimension | | | | | | | | | | | | | | | | 外 形 尺 寸 Overall Dimension | | | | | | | |
|--------------|-------------|----------------------------|-----|-----|----|-----|----|------|-----|----|-----|-----|-----|---|----|-----|------|---------------------------|-----|----|-----|-----|-----|-----|-----|
| | | A | B | C | D | E | F | G | H | K | M | N | P | R | S | T | 凸缘孔数 | AA | BB | HA | AB | AC | AD | HD | L |
| 80M | 2,4,6,8 | 125 | 100 | 50 | 19 | 40 | 6 | 15.5 | 80 | 10 | 165 | 130 | 200 | 0 | 12 | 3.5 | 4 | 34 | 150 | 10 | 165 | 165 | 180 | 300 | 330 |
| 90S | 2,4,6,8 | 140 | 100 | 56 | 24 | 50 | 8 | 20 | 90 | 10 | 165 | 130 | 200 | 0 | 12 | 35 | 4 | 36 | 140 | 14 | 180 | 180 | 180 | 350 | 360 |
| 90L | | | 125 | | | | | | | | | | | | | | | 165 | 385 | | | | | | |
| 100L | 2,4,6,8 | 160 | 140 | 63 | 28 | 60 | 8 | 24 | 100 | 12 | 215 | 180 | 250 | 0 | 15 | 4 | 4 | 40 | 190 | 14 | 200 | 205 | 180 | 400 | 440 |
| 112M | 2,4,6,8 | 190 | | 70 | | | | | 112 | | | | | | | | | 50 | 180 | | | | | | 16 |
| 132S | 2,4,6,8 | 216 | 140 | 89 | 38 | 80 | 10 | 33 | 132 | 12 | 265 | 230 | 300 | 0 | 15 | 4 | 4 | 60 | 190 | 18 | 280 | 270 | 200 | 450 | 510 |
| 132M | | | 178 | | | | | | | | | | | | | | | 230 | 550 | | | | | | |
| 160M | 2,4,6,8 | 254 | 210 | 108 | 42 | 110 | 12 | 37 | 160 | 15 | 300 | 250 | 350 | 0 | 19 | 5 | 4 | 70 | 253 | 25 | 330 | 325 | 220 | 520 | 670 |
| 160L | | | 254 | | | | | | | | | | | | | | | 297 | 710 | | | | | | |

| | | | | | | | | | | | | | | | | | | | | | | | | | |
|------|----------|-----|-----|-----|----|-----|----|------|-----|----|-----|-----|-----|---|----|---|---|-----|-----|----|-----|-----|-----|------|------|
| 180M | 2,4,6,8 | 279 | 241 | 121 | 48 | 110 | 14 | 42.5 | 180 | 15 | 300 | 250 | 350 | 0 | 19 | 5 | 4 | 70 | 315 | 22 | 355 | 360 | 220 | 550 | 730 |
| 180L | | | 279 | | | | | | | | | | | | | | | | 350 | | | | | | 750 |
| 200L | 2,4,6,8 | 318 | 305 | 133 | 55 | 110 | 16 | 49 | 200 | 19 | 350 | 300 | 400 | 0 | 19 | 5 | 4 | 70 | 366 | 25 | 390 | 400 | 250 | 645 | 805 |
| 225S | 4,8 | 356 | 286 | 149 | 60 | 140 | 18 | 53 | 225 | 19 | 400 | 350 | 450 | 0 | 19 | 5 | 8 | 75 | 355 | 28 | 435 | 450 | 250 | 690 | 865 |
| 225M | 2 | | 311 | | 55 | 110 | 16 | 49 | | | | | | | | | | | 388 | | | | | | 860 |
| | 4,6,8 | | | | 60 | 140 | 18 | 53 | | | | | | | | | | | | | | | | | 890 |
| 250M | 2 | 406 | 349 | 168 | 60 | 140 | 18 | 53 | 250 | 24 | 500 | 450 | 550 | 0 | 19 | 5 | 8 | 80 | 420 | 30 | 490 | 500 | 300 | 730 | 945 |
| | 4,6,8 | | | | 65 | | | 58 | | | | | | | | | | | | | | | | | 58 |
| 280S | 2 | 457 | 368 | 190 | 65 | 140 | 18 | 58 | 280 | 24 | 500 | 450 | 550 | 0 | 19 | 5 | 8 | 90 | 458 | 35 | 545 | 565 | 300 | 810 | 1010 |
| | 4,6,8 | | | | 75 | | | 20 | | | | | | | | | | | | | | | | | 67.5 |
| 280M | 2 | 419 | | | 65 | | | 58 | | | | | | | | | | | 509 | | | | | | 1060 |
| | 4,6,8 | | | | 75 | | | 20 | | | | | | | | | | | | | | | | | 67.5 |
| 315S | 2 | 508 | 406 | 216 | 65 | 140 | 18 | 58 | 315 | 28 | 600 | 550 | 660 | 0 | 24 | 6 | 8 | 120 | 570 | 45 | 640 | 630 | 400 | 1020 | 1320 |
| | 4,6,8,10 | | | | 80 | 170 | 22 | 71 | | | | | | | | | | | | | | | | | 1350 |
| 315M | 2 | 508 | 457 | 216 | 65 | 140 | 18 | 58 | 315 | 28 | 600 | 550 | 660 | 0 | 24 | 6 | 8 | 120 | 680 | 45 | 640 | 630 | 400 | 1020 | 1350 |
| | 4,6,8,10 | | | | 80 | 170 | 22 | 71 | | | | | | | | | | | | | | | | | 1380 |
| 315L | 2 | 508 | | | 65 | 140 | 18 | 58 | | | | | | | | | | | | | | | | | 1490 |
| | 4,6,8,10 | | | | 80 | 170 | 22 | 71 | | | | | | | | | | | | | | | | | 1520 |
| 355S | 2 | 610 | 500 | 254 | 75 | 140 | 20 | 67.5 | 355 | 28 | 740 | 680 | 800 | 0 | 24 | 6 | 8 | 116 | 636 | 50 | 740 | 750 | 500 | 1080 | 1570 |
| | 4,6,8,10 | | | | 95 | 170 | 25 | 86 | | | | | | | | | | | | | | | | | 1570 |
| 355M | 2 | 610 | 560 | 254 | 75 | 140 | 20 | 67.5 | 355 | 28 | 740 | 680 | 800 | 0 | 24 | 6 | 8 | 116 | 696 | 50 | 740 | 750 | 500 | 1080 | 1650 |
| | 4,6,8,10 | | | | 95 | 170 | 25 | 86 | | | | | | | | | | | | | | | | | 1650 |
| 355L | 2 | 630 | | | 75 | 140 | 20 | 67.5 | | | | | | | | | | | 766 | | | | | | 1750 |
| | 4,6,8,10 | | | | 95 | 170 | 25 | 86 | | | | | | | | | | | | | | | | | 1750 |

冷却风机参数 Specifications of cooling blower

| 电机 Motor | 机座号 Frame | 80 | 90 | 100 | 112 | 132 | 160 | 180 | 200 | 225 | 250 | 280 | 315 | 355 |
|---------------------|-----------------|--|----|-----|-----|-----|-----|-----|-----|-----|-----|-----|-----|-----|
| 冷却风机 Cooling Fan | 功率 (W) Power | 35 | 50 | 65 | 70 | 80 | 90 | 100 | 180 | 180 | 370 | 370 | 800 | 800 |
| | 电压 Voltage | 通常情况是三相 380V，但可以根据客户的要求定制各种电压 Standard voltage is 380V, but blower of other voltage can be also customized. | | | | | | | | | | | | |

注：冷却风机功率仅供参考，以实物为准。Power here is indicative only. Actual product may differ.

常用的安装结构型式，以及适用的机座号见下表

Conventional mounting type and suitable frame size are given in following table (with “√”)

| 机座号 Frame | 基本安装结构 | | | 派生的安装形式 | | | | | | | | | | | |
|--------------|--------|----|-----|---------|----|----|----|----|----|----|-----|-----|-----|-----|-----|
| | B3 | B5 | B35 | V1 | V3 | V5 | V6 | B6 | B7 | B8 | V15 | V36 | B14 | B34 | V18 |
| 80~112 | √ | √ | √ | √ | √ | √ | √ | √ | √ | √ | √ | √ | √ | √ | √ |
| 132~160 | √ | √ | √ | √ | √ | √ | √ | √ | √ | √ | √ | √ | - | - | - |
| 180~280 | √ | √ | √ | √ | - | - | - | - | - | - | - | - | - | - | - |
| 315~355 | √ | - | √ | √ | - | - | - | - | - | - | - | - | - | - | - |

“√”表示可以制造生产的结构型式，电机订购时，若不作说明的接线盒为顶式。以上数据，如有变更，恕不另行通知。

If there is no other request in the order or agreement, terminal box position at top of the frame is regarded as standard ; data above may be changed without prior notice.