

## YRKS series (H355-630) medium-sized high-voltage three-phase asynchronous motor

The YRKS series of medium-sized 6kV wound-rotor three-phase asynchronous motors is a new series of products that our company has optimized and designed by introducing and assimilating advanced technology from Westinghouse Electric Company of the United States, combined with our decades of experience in motor manufacturing. It is an updated and upgraded product of the JR old series.

The YRKS series medium-sized 10kV wound-rotor three-phase asynchronous motors are another new series of products carefully crafted by our company, based on the successful development of the medium-sized 6kV wound-rotor three-phase asynchronous motors. This series of motors can be directly used in 10kV power grids. Compared to 6kV motors, they offer advantages such as simplified equipment, reliable operation, investment savings, and reduced energy consumption.

The rotor coils of the YRKS series motor utilize copper bars coated with Class F insulation material. Silver-copper welding is employed between coils and between the outgoing copper bars and coils to ensure the reliability of the motor's operation.

The YRKS series motor adopts a box-type structure welded from steel plates, featuring light weight and good rigidity. It is equipped with a protective top cover on the top, which is easy to disassemble and maintain. The stator adopts an external press-fit structure, with stator windings having Class F insulation and VPI impregnation, providing excellent and reliable insulation performance, good mechanical strength, and strong moisture resistance. The protection level is IP23, and it can be made to meet IP54 standards upon request.

The stator coil is embedded with temperature measuring components to observe changes in coil temperature. The specifications of the temperature measuring components can be customized according to user requirements. If a heater is required to be added inside the motor, it must be specified when ordering. The motor cable outlet is generally located at the lower part of the motor, or an outlet box can be designed according to customer requirements. The outlet box must be installed on the wall of the motor base.



## YRKS 系列电动机型谱 (6kV)

## YRKS series motor model composition (6kV)

机座号 Frame		同步转速 r/min				
		1500	1000	750	600	500
		功率 kW				
355	1	220	—	—	—	—
	2	250				
	3	280				
400	1	315	220	—	—	—
	2	355	250	—		
	3	400	280	220		
	4	450	315	250		
	5	500	355	280		
450	1	560	400	315	220	—
	2	630	450	355	250	—
	3	710	500	400	280	—
	4	800	560	450	315	220
	5	—	—	—	355	250
500	1	900	630	500	400	280
	2	1000	710	560	450	315
	3	1120	800	630	500	355
	4	1250	900	710	560	400
560	1	1400	1000	800	630	450
	2	1600	1120	900	710	500
	3	1800	1250	1000	800	560
	4	—	—	—	—	630
630	1	2000	1400	1120	900	710
	2	2240	1600	1250	1000	800
	3	2500	1800	1400	1120	900
	4	—	—	1600 <sup>(1)</sup>	1250 <sup>(1)</sup>	1000 <sup>(1)</sup>

注：(1)的功率允许放入 710 机座。

## YRKS 系列电动机型谱 (10kV)

## YRKS series motor model composition (10kV)

机座号 Frame		同步转速 r/min				
		1500	1000	750	600	500
		功率 kW				
450	1	315	—	—	—	—
	2	355	—			
	3	400	280			
	4	450	315			
	5	500	355			
	6	560	400			
500	1	630	450	280	—	—
	2	710	500	315	—	
	3	800	560	355	250	
	4	900	630	400	280	
	5	1000	710	450	315	
	6	—	—	500	355	
560	1	1120	800	560	400	280
	2	1250	900	630	450	315
	3	1400	1000	710	500	355
	4	—	1120	800	560	400
	5	—	—	—	630	450
630	1	1600	1250	900	710	500
	2	1800	1400	1000	800	560
	3	2000	1600	1120	900	630
	4	—	—	—	1000	710

YRKS(IP54)系列技术数据 ( 6kV )  
 YRKS(IP54) series technical data (6kV)

型号 Type	额定 功率 (kW)	定子 电流 (A)	转速 (r/min)	效率 (%)	功率 因数 Cos Φ	最大转矩 额定转矩 $\frac{T_m}{T_n}$	转子 电压 (V)	转子 电流 (A)	电机 转动惯量 $J_m$ ( $kg \cdot m^2$ )	重量 (kg)	
										YR	YRKS
YRKS355 1-4	220	27.5	1490	92.7	0.83	1.8	284	489	5	1940	2300
YRKS355 2-4	250	30.8	1490	93.0	0.84	1.8	303	521	5	1980	2340
YRKS355 3-4	280	34.5	1490	93.1	0.84	1.8	334	526	6	2040	2400
YRKS400 1-4	315	38.3	1490	93.2	0.85	1.8	362	543	8	2500	2960
YRKS400 2-4	355	43.1	1490	93.3	0.85	1.8	392	564	9	2580	3040
YRKS400 3-4	400	48.4	1490	93.5	0.85	1.8	428	581	10	2670	3130
YRKS400 4-4	450	54.4	1490	93.7	0.85	1.8	458	612	10	2770	3230
YRKS400 5-4	500	60.3	1490	93.9	0.85	1.8	509	609	11	2870	3330
YRKS450 1-4	560	67.3	1490	94.2	0.85	1.8	713	487	16	3480	4010
YRKS450 2-4	630	74.6	1490	94.5	0.86	1.8	792	491	17	3570	4100
YRKS450 3-4	710	84.0	1490	94.6	0.86	1.8	867	505	18	3700	4230
YRKS450 4-4	800	93.4	1490	94.7	0.87	1.8	1020	480	21	3950	4480
YRKS500 1-4	900	105.0	1490	94.8	0.87	1.8	799	693	33	4560	5200
YRKS500 2-4	1000	116.6	1490	94.9	0.87	1.8	872	703	36	4730	5370
YRKS500 3-4	1120	130.4	1490	95.0	0.87	1.8	983	697	41	5060	5700
YRKS500 4-4	1250	145.4	1490	95.1	0.87	1.8	1090	699	44	5240	5880
YRKS560 1-4	1400	162.7	1490	95.2	0.87	1.8	1275	672	82	6770	7560
YRKS560 2-4	1600	185.7	1490	95.3	0.87	1.8	1400	697	87	7000	7790
YRKS560 3-4	1800	208.7	1490	95.4	0.87	1.8	1558	704	96	7200	7990
YRKS630 1-4	2000	231.6	1490	95.5	0.87	1.8	1600	758	113	9160	9880
YRKS630 2-4	2240	259.2	1490	95.6	0.87	1.8	1755	776	124	9560	10280
YRKS630 3-4	2500	288.9	1490	95.7	0.87	1.8	2000	754	132	9780	10500
YRKS400 1-6	220	28.3	990	92.5	0.81	1.8	289	480	13	2490	2950
YRKS400 2-6	250	31.6	990	92.7	0.82	1.8	310	509	14	2530	2990
YRKS400 3-6	280	35.4	990	92.8	0.82	1.8	334	529	15	2590	3050
YRKS400 4-6	315	39.7	990	93.0	0.82	1.8	362	549	16	2680	3140
YRKS400 5-6	355	44.7	990	93.2	0.82	1.8	395	566	18	2780	3240
YRKS450 1-6	400	49.6	990	93.5	0.83	1.8	662	379	21	3340	3970
YRKS450 2-6	450	55.1	990	93.6	0.84	1.8	728	387	22	3530	4060
YRKS450 3-6	500	61.1	990	93.8	0.84	1.8	809	385	24	3640	4170
YRKS450 4-6	560	68.2	990	94.0	0.84	1.8	912	382	28	3890	4420
YRKS500 1-6	630	75.6	990	94.3	0.85	1.8	849	461	44	4470	5110
YRKS500 2-6	710	85.1	990	94.5	0.85	1.8	917	481	48	4630	5270
YRKS500 3-6	800	95.6	990	94.7	0.85	1.8	1049	472	55	4950	5590
YRKS500 4-6	900	107.5	990	94.8	0.85	1.8	1156	481	59	5090	5730
YRKS560 1-6	1000	119.2	990	95.0	0.85	1.8	1130	544	100	6550	7340
YRKS560 2-6	1120	133.3	990	95.1	0.85	1.8	1225	562	107	6830	7620
YRKS560 3-6	1250	148.6	990	95.2	0.85	1.8	1340	574	117	6970	7760
YRKS630 1-6	1400	166.3	990	95.3	0.85	1.8	1470	679	158	8860	9580
YRKS630 2-6	1600	188.9	990	95.4	0.85	1.8	1640	595	175	9290	10010
YRKS630 3-6	1800	213.4	990	95.5	0.85	1.8	1795	612	186	9500	10220
YRKS400 3-8	220	29.4	740	92.2	0.78	1.8	432	325	16	2670	3130
YRKS400 4-8	250	33.4	740	92.3	0.78	1.8	464	346	18	2750	3210
YRKS400 5-8	280	36.9	740	92.5	0.79	1.8	500	360	19	2840	3300

## YRKS(IP54)系列技术数据 ( 6kV )

## YRKS(IP54) series technical data (6kV).

型号 Type	额定 功率 (kW)	定子 电流 (A)	转速 (r/min)	效率 (%)	功率 因数 Cos Φ	最大转矩 额定转矩 $\frac{T_m}{T_n}$	转子 电压 (V)	转子 电流 (A)	电机 转动惯量 $J_m$ (kg.m <sup>2</sup> )	重量 (kg)	
										YR	YRKS
YRKS450 1-8	315	40.9	740	92.6	0.80	1.8	572	351	23	3520	4050
YRKS450 2-8	355	46.1	740	92.7	0.80	1.8	621	365	24	3600	4130
YRKS450 3-8	400	51.7	740	93.0	0.80	1.8	678	378	26	3740	4270
YRKS450 4-8	450	57.4	740	93.2	0.81	1.8	746	385	28	3860	4390
YRKS500 1-8	500	63.5	740	93.5	0.81	1.8	682	465	40	4320	4960
YRKS500 2-8	560	71.0	740	93.7	0.81	1.8	753	473	47	4580	5220
YRKS500 3-8	630	79.7	740	93.9	0.81	1.8	837	477	51	4770	5410
YRKS500 4-8	710	89.7	740	94.0	0.81	1.8	943	477	58	5060	5700
YRKS560 1-8	800	100.9	740	94.2	0.81	1.8	880	573	121	6310	7100
YRKS560 2-8	900	113.4	740	94.3	0.81	1.8	996	568	128	6510	7300
YRKS560 3-8	1000	125.8	740	94.4	0.81	1.8	1140	548	141	6780	7570
YRKS630 1-8	1120	140.8	740	94.5	0.81	1.8	1266	548	164	8600	9320
YRKS630 2-8	1250	157.0	740	94.6	0.81	1.8	1380	560	175	8830	9550
YRKS630 3-8	1400	175.6	740	94.7	0.81	1.8	1516	569	183	9140	9860
YRKS630 4-8	1600	200.5	740	94.8	0.81	1.8	1682	584	195	9490	10210
YRKS450 1-10	220	30.4	590	90.3	0.77	1.8	534	264	27	3320	3850
YRKS450 2-10	250	34.5	590	90.5	0.77	1.8	575	280	29	3410	3940
YRKS450 3-10	280	37.6	590	91.8	0.78	1.8	625	288	32	3500	4030
YRKS450 4-10	315	42.3	590	91.9	0.78	1.8	681	297	34	3610	4140
YRKS450 5-10	355	47.6	590	92.1	0.78	1.8	749	304	37	3720	4250
YRKS500 1-10	400	53.2	590	92.8	0.78	1.8	677	376	57	4370	5010
YRKS500 2-10	450	59.6	590	93.1	0.78	1.8	744	384	62	4530	5170
YRKS500 3-10	500	65.3	590	93.3	0.79	1.8	827	382	67	4680	5320
YRKS500 4-10	560	73.0	590	93.5	0.79	1.8	932	379	77	5030	5670
YRKS560 1-10	630	81.0	590	93.6	0.80	1.8	1068	369	113	6210	7000
YRKS560 2-10	710	91.1	590	93.7	0.80	1.8	1159	388	125	6370	7160
YRKS560 3-10	800	102.6	590	93.8	0.80	1.8	1255	404	132	6510	7300
YRKS630 1-10	900	115.3	590	93.9	0.80	1.8	1255	448	153	8320	9040
YRKS630 2-10	1000	127.8	590	94.1	0.80	1.8	1370	456	166	8710	9430
YRKS630 3-10	1120	143.0	590	94.2	0.80	1.8	1510	464	182	9030	9750
YRKS630 4-10	1250	159.4	590	94.3	0.80	1.8	1668	465	196	9240	9960
YRKS450 4-12	220	32.2	490	90.4	0.72	1.8	519	279	33	3600	4130
YRKS450 5-12	250	36.5	490	91.5	0.72	1.8	590	275	36	3720	4250
YRKS500 1-12	280	40.3	490	91.7	0.73	1.8	552	326	53	4290	4930
YRKS500 2-12	315	44.5	490	92.0	0.74	1.8	593	343	58	4380	5020
YRKS500 3-12	355	49.5	490	92.1	0.75	1.8	639	360	62	4430	5070
YRKS500 4-12	400	55.6	490	92.3	0.75	1.8	694	375	67	4590	5230
YRKS560 1-12	450	60.8	490	92.5	0.77	1.8	770	372	128	5580	6670
YRKS560 2-12	500	67.4	490	92.7	0.77	1.8	845	375	137	6040	6830
YRKS560 3-12	560	75.4	490	92.8	0.77	1.8	942	377	152	6260	7050
YRKS560 4-12	630	84.7	490	92.9	0.77	1.8	1060	376	169	6410	7200
YRKS630 1-12	710	95.4	490	93.0	0.77	1.8	1032	429	204	8000	8720
YRKS630 2-12	800	107.4	490	93.1	0.77	1.8	1120	446	222	8260	8980
YRKS630 3-12	900	120.7	490	93.2	0.77	1.8	1223	460	244	8560	9280
YRKS630 4-12	1000	128.9	490	93.3	0.77	1.8	1342	464	256	8760	9480

注：表中性能数据对应的保证值见附表。

Note: These property data shown in table which in correspondence with these guaranteed values are shown in the additive table.

YRKS 系列 (6 kV) 中型电动机外形及安装尺寸

(mm)

YRKS series (6 kV) medium type asynchronous motor overall and mounting dimensions figure

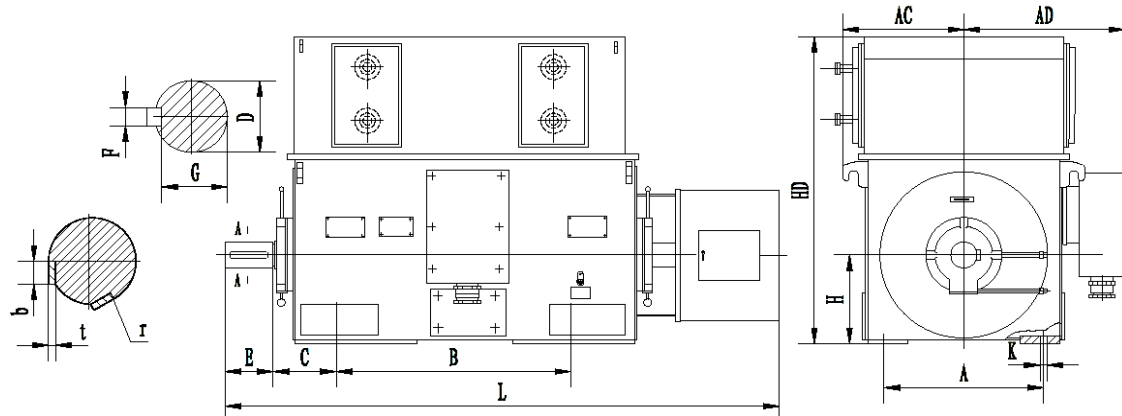

机座	极数	安装尺寸及公差												外形尺寸 (限值)			
		A	B	C <sup>(3)</sup>	D	E	F	G	t	b	r	H	K	AC	AD	HD	L
355	4	630 ± 1.4	900 ± 1.4	315 ± 4.0	100 <sup>+0.035</sup> / <sub>+0.013</sub>	210 ± 0.57	28 <sup>0</sup> / <sub>-0.062</sub>	90 <sup>0</sup> / <sub>-0.2</sub>	—	—	—	355 <sup>0</sup> / <sub>-1.0</sub>	28 <sup>+0.62</sup> / <sub>0</sub>	550	760	1500	2400
400	4-8	710 ± 1.75	1000 ± 1.75	355 ± 4.0	110 <sup>+0.035</sup> / <sub>+0.013</sub>		100 <sup>0</sup> / <sub>-0.2</sub>	—	—	—	—	400 <sup>0</sup> / <sub>-1.0</sub>	35 <sup>+0.62</sup> / <sub>0</sub>	575	820	1700	2450
450	4	800 ± 1.75	1120 ± 1.75	355 ± 4.0	120 <sup>+0.035</sup> / <sub>+0.013</sub>		32 <sup>0</sup> / <sub>-0.062</sub>	109 <sup>0</sup> / <sub>-0.2</sub>	—	—	—	450 <sup>0</sup> / <sub>-1.0</sub>		600	850	1900	2640
450	6-12				130 <sup>+0.040</sup> / <sub>+0.015</sub>	119 <sup>0</sup> / <sub>-0.2</sub>		—	—	—	600	850	1900	2640			
500	4	900 ± 2.1	1250 ± 2.1	475 ± 4.0	250 ± 0.57	36 <sup>0</sup> / <sub>-0.062</sub>	128 <sup>0</sup> / <sub>-0.2</sub>	—	—	—	500 <sup>0</sup> / <sub>-1.0</sub>	42 <sup>+0.62</sup> / <sub>0</sub>	660	920	2200	2920	
500	6-12												140 <sup>+0.040</sup> / <sub>+0.015</sub>	—	—	—	660
560	4	1000 ± 2.1	1400 ± 2.1 <sup>(1)</sup>	500 ± 4.0	150 <sup>+0.040</sup> / <sub>+0.015</sub>	—	—	11.4 <sup>+0.2</sup> / <sub>0</sub>	39.7	0.7	1.0		560 <sup>0</sup> / <sub>-1.0</sub>	800	1210	2400	3200
560	6-12		1600 ± 2.1		160 <sup>+0.040</sup> / <sub>+0.015</sub>	—	—	—	42.8	0.7	1.0		800	1210	2400	3200	
630	4	1120 ± 2.1	1600 ± 2.1 <sup>(2)</sup>	530 ± 4.0	300 ± 0.65	—	—	12.4 <sup>+0.3</sup> / <sub>0</sub>	44.2	0.7	1.0	600 <sup>0</sup> / <sub>-1.0</sub>	48 <sup>+0.62</sup> / <sub>0</sub>	860	1260	2700	3560
630	6-12		1800 ± 2.1						180 <sup>+0.040</sup> / <sub>+0.015</sub>	—	—			—	45.6	0.7	1.0

注：(1) 1400 为集电环置于轴承外侧时的数值；1600 为集电环置于轴承内测时的数值。(2) 1600 为集电环置于轴承外侧时的数值；1800 为集电环置于轴承内测时的数值。(3) 采用滑动轴承时，偏差不包括轴向串动量

## YRKS 系列技术数据 (10kV)

## YRKS series technical data (10kV)

型号 Type	额定 功率 (kW)	定子 电流 (A)	转速 (r/min)	效率 (%)	功率 因数 Cos Φ	最大转矩 额定转矩 $\frac{T_m}{T_n}$	转子 电压 (V)	转子 电流 (A)	电机 转动惯量 J m (kg.m <sup>2</sup> )	重量 (kg)	
										YR	YRKS
YRKS450 1-4	315	23.4	1490	92.5	0.84	1.8	485	399	12	3800	4275
YRKS450 2-4	355	26.3	1490	92.8	0.84	1.8	485	451	12.9	3800	4275
YRKS450 3-4	400	29.2	1490	93.1	0.85	1.8	546	449	12.9	4100	4580
YRKS450 4-4	450	32.8	1490	93.3	0.85	1.8	546	508	13.8	4100	4580
YRKS450 5-4	500	36.3	1490	93.6	0.85	1.8	624	491	13.8	4500	4975
YRKS450 6-4	560	40.6	1490	93.8	0.85	1.8	624	553	14.7	4500	4975
YRKS500 1-4	630	45.4	1490	94.2	0.85	1.8	672	575	22	4600	5180
YRKS500 2-4	710	51.0	1490	94.6	0.85	1.8	729	597	23	4800	5380
YRKS500 3-4	800	56.7	1490	94.7	0.86	1.8	795	615	25	5000	5580
YRKS500 4-4	900	63.7	1490	94.8	0.86	1.8	795	696	27	5000	5580
YRKS500 5-4	1000	70.7	1490	94.9	0.86	1.8	976	632	29	6300	6580
YRKS560 1-4	1120	78.2	1490	95.1	0.87	1.8	1173	583	40	6500	7300
YRKS560 2-4	1250	87.1	1490	95.2	0.87	1.8	1173	655	43	6500	7300
YRKS560 3-4	1400	97.5	1490	95.3	0.87	1.8	1299	661	46	8800	9600
YRKS630 1-4	1600	110.0	1490	95.4	0.88	1.8	1463	668	86	9000	9585
YRKS630 2-4	1800	123.7	1490	95.5	0.88	1.8	1463	757	91	9000	9585
YRKS630 3-4	2000	137.3	1490	95.6	0.88	1.8	1674	730	96	9600	10185
YRKS450 3-6	280	21.6	990	92.2	0.81	1.8	611	287	14.7	3500	3980
YRKS450 4-6	315	24.3	990	92.4	0.81	1.8	763	256	15.7	3700	4180
YRKS450 5-6	355	27.3	990	92.6	0.81	1.8	815	270	17.1	3900	4380
YRKS450 6-6	400	30.7	990	92.8	0.81	1.8	815	306	18.2	3900	4380
YRKS500 1-6	450	34.5	990	93.1	0.81	1.8	817	339	23	4200	4780
YRKS500 2-6	500	38.2	990	93.4	0.81	1.8	876	351	25	4400	4980
YRKS500 3-6	560	42.7	990	93.6	0.81	1.8	944	365	27	4500	5080
YRKS500 4-6	630	47.3	990	93.8	0.82	1.8	944	413	29	4500	5080
YRKS500 5-6	710	53.2	990	94.0	0.82	1.8	941	467	31	6200	6780
YRKS560 1-6	800	58.3	990	94.3	0.84	1.8	1021	484	49	6400	7200
YRKS560 2-6	900	65.5	990	94.5	0.84	1.8	1150	498	53	6600	7400
YRKS560 3-6	1000	71.7	990	94.7	0.85	1.8	1114	555	56	7650	8450
YRKS560 4-6	1120	80.2	990	94.9	0.85	1.8	1226	563	60	7800	8600
YRKS630 1-6	1250	89.3	990	95.1	0.85	1.8	1364	564	114	8600	9185
YRKS630 2-6	1400	99.8	990	95.3	0.85	1.8	1535	558	121	8800	9385
YRKS630 3-6	1600	113.4	990	95.4	0.85	1.8	1700	560	128	9000	9585
YRKS500 1-8	280	23.4	740	92.2	0.75	1.8	525	341	22	4200	4710
YRKS500 2-8	315	26.3	740	92.3	0.75	1.8	573	344	24	4400	4910
YRKS500 3-8	355	29.5	740	92.5	0.75	1.8	632	352	26	4600	5110
YRKS500 4-8	400	33.2	740	92.8	0.75	1.8	704	355	28	4800	5310
YRKS500 5-8	450	36.2	740	93.1	0.77	1.8	794	353	30	5000	5510
YRKS500 6-8	500	40.2	740	93.3	0.77	1.8	794	396	32	5000	5510

## YRKS 系列技术数据 (10kV)

## YRKS series technical data (10kV)

型号 Type	额定 功率 (kW)	定子 电流 (A)	转速 (r/min)	效率 (%)	功率 因数 CosΦ	最大转矩 额定转矩 $\frac{T_m}{T_n}$	转子 电压 (V)	转子 电流 (A)	电机 转动惯量 Jm (kg.m <sup>2</sup> )	重量 (kg)	
										YR	YRKS
YRKS560 1-8	560	43.7	740	93.6	0.79	1.8	843	414	56	6100	6900
YRKS560 2-8	630	49.1	740	93.8	0.79	1.8	905	436	60	6300	7100
YRKS560 3-8	710	55.2	740	94.0	0.79	1.8	974	456	63	6500	7300
YRKS560 4-8	800	62.0	740	94.2	0.79	1.8	970	515	67	6700	7500
YRKS630 1-8	900	67.1	740	94.4	0.82	1.8	1052	534	141	7900	8485
YRKS630 2-8	1000	74.4	740	94.6	0.82	1.8	1148	544	149	8500	9085
YRKS630 3-8	1120	83.2	740	94.8	0.82	1.8	1264	553	157	8800	9385
YRKS500 3-10	250	21.9	590	91.4	0.72	1.8	737	212	28	4400	4910
YRKS500 4-10	280	24.5	590	91.7	0.72	1.8	737	238	30	4600	5110
YRKS500 5-10	315	27.4	590	92.1	0.72	1.8	785	252	32	4800	5310
YRKS500 6-10	355	30.9	590	92.2	0.72	1.8	785	286	32	4800	5310
YRKS560 1-10	400	33.8	590	92.4	0.74	1.8	837	303	75	5700	6500
YRKS560 2-10	450	37.3	590	92.8	0.75	1.8	837	345	80	5900	6700
YRKS560 3-10	500	41.4	590	93.0	0.75	1.8	960	326	84	6100	6900
YRKS560 4-10	560	45.7	590	93.2	0.76	1.8	1041	338	89	6300	7100
YRKS560 5-10	630	51.2	590	93.4	0.76	1.8	1137	347	94	6500	7300
YRKS630 1-10	710	56.1	590	93.7	0.78	1.8	1007	445	144	7600	7185
YRKS630 2-10	800	63.1	590	93.8	0.78	1.8	1092	463	153	7900	8485
YRKS630 3-10	900	70.9	590	93.9	0.78	1.8	1193	477	161	8500	9085
YRKS630 4-10	1000	78.7	590	94.1	0.78	1.8	1314	481	169	8800	9385
YRKS500 1-12	280	24.6	490	91.4	0.72	1.8	608	295	73	5000	5800
YRKS500 2-12	315	27.6	490	91.5	0.72	1.8	610	337	77	5000	5800
YRKS500 3-12	355	31.1	490	91.6	0.72	1.8	681	328	82	6100	6900
YRKS500 4-12	400	34.9	490	91.8	0.72	1.8	728	348	87	6300	7100
YRKS500 5-12	450	39.1	490	92.2	0.72	1.8	781	366	92	6500	7300
YRKS630 1-12	500	42.8	490	92.4	0.73	1.8	783	400	119	7600	8185
YRKS630 2-12	560	47.1	490	92.8	0.74	1.8	844	416	136	7900	8485
YRKS630 3-12	630	52.8	490	93.1	0.74	1.8	915	433	152	8500	9085
YRKS630 4-12	710	59.3	490	93.4	0.74	1.8	998	447	160	8800	9385

注：表中性能数据对应的保证值见附表。

Note: These property data shown in table which in correspondence with these guaranteed values are shown in the additive table.

